



ALRITE

ALRITE STEEL & SERVICES NZ LTD

STEEL PRODUCTS



QAS INTERNATIONAL
ISO 9001:2015
REGISTERED COMPANY
Certificate No. NZ1081

WELCOME TO

ALRITE STEEL & SERVICES NZ LIMITED

Alrite Steel & Services NZ Ltd are importers, stockists and distributors of all types of building and civil construction steel with three warehouses throughout New Zealand.

With over 30 years' of industry knowledge and experience Alrite has earned an enviable reputation for outstanding customer service and supply of high quality compliant steel products. Alrite's key competency is their supply of materials on "Indent" direct to their clients and end users.

We carry a modest amount of steel stock and are able to supply the whole range of commonly used Hollows (SHS, RHS, CHS), Structural Steel UBs, UCs, Channels, Angles, Flat Bars, Sheet / Circular and Bearing H Piles, HR & CR Coils, Sheets and Plates. These can be available ex our stock and/or offshore stock within 2-6 weeks. Products are available in various specifications, standards and grades in 6, 8, 9 & 12m lengths or to required lengths from mill rolling.

**Our team specializes in
supplying all types of steel
and associated products to
top mark quality.**

STEEL PRODUCTS CATALOGUE

TABLE OF CONTENTS

SQUARE HOLLOW SECTIONS	1
RECTANGULAR HOLLOW SECTIONS	4
CIRCULAR HOLLOW SECTIONS	7
UNIVERSAL BEAMS	10
UNIVERSAL COLUMNS	13
PARALLEL FLANGE ANGLES (PFCS)	15
ANGLES	17
FLAT BARS	19
PLATES	22
REBAR	24
STRAPPING	26
PURLINS	28
PROJECTS	31

SQUARE HOLLOW SECTIONS

SQUARE HOLLOW SECTIONS - SHS

AS/NZS 1163:2016 C350LO

Finish: Black/Blue Painted, Mill Finish, NOPC, Pre Galvanised, Hot Dipped Galvanised

Standard Lengths: 8m & 12m.

Different standards/grades and lengths available upon request.

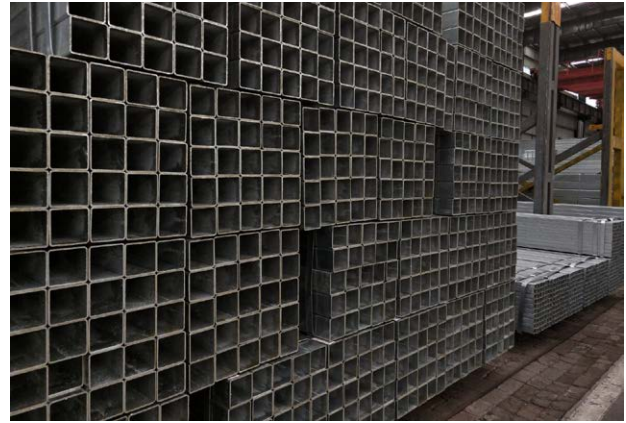

SIZE	WALL THICKNESS	WEIGHT
mm	mm	kg/m
20 x 20	1.6	0.87
	1.6	1.12
25 x 25	2.0	1.36
	2.5	1.64
	3.0	1.89
30 x 30	1.6	1.38
	2.0	1.68
	2.5	2.03
	3.0	2.36
35 x 35	1.6	1.63
	2.0	1.99
	2.5	2.42
40 x 40	3.0	2.83
	1.6	1.88
	2.0	2.31
50 x 50	2.5	2.82
	3.0	3.30
	4.0	4.09
	1.6	2.38
50 x 50	2.0	2.93
	2.5	3.60
	3.0	4.25
	4.0	5.35
	5.0	6.39
	6.0	7.32

SIZE	WALL THICKNESS	WEIGHT
mm	mm	kg/m
65 x 65	2.5	4.78
	3.0	5.66
	4.0	7.23
	5.0	8.75
75 x 75	6.0	10.09
	2.5	5.56
	3.0	6.60
	3.5	7.53
89 x 89	4.0	8.49
	5.0	10.30
	6.0	12.00
	3.5	9.07
100 x 100	4.0	10.40
	5.0	12.50
	6.0	14.70
	2.5	7.49
125 x 125	3.0	8.96
	4.0	11.60
	5.0	14.20
	6.0	16.70
	8.0	21.40
	9.0	23.60
125 x 125	4.0	14.80
	5.0	18.20
	6.0	21.40
	8.0	27.70
125 x 125	9.0	30.60

SQUARE HOLLOW SECTIONS - SHS

AS/NZS 1163:2009 C350LO

SIZE	WALL THICKNESS	WEIGHT
mm	mm	kg/m
150 x 150	4.0	17.90
	5.0	22.10
	6.0	26.20
	8.0	33.90
	9.0	37.70
200 x 200	5.0	29.90
	6.0	35.60
	8.0	46.50
	9.0	51.80
	10.0	57.00
250 x 250	12.5	69.40
	6.0	45.00
	8.0	59.10
	9.0	65.90
	10.0	72.70
300 x 300	12.5	89.00
	6.0	54.40
	8.0	71.60
	9.0	80.10
	10.0	88.40
	12.5	109.00



RECTANGULAR HOLLOW SECTIONS

RECTANGULAR HOLLOW SECTIONS - RHS

AS/NZS 1163:2016 C350LO

Finish: Black/Blue Painted, Mill Finish, NOPC, Pre Galvanised, Hot Dipped Galvanised

Standard Lengths: 8m & 12m.

Different standards/grades and lengths available upon request.



SIZE	WALL THICKNESS	WEIGHT
mm	mm	kg/m
50 X 25	1.6	1.75
	2.0	2.15
	2.5	2.62
	3.0	3.07
65 X 35	2.0	2.93
	2.5	3.60
	3.0	4.25
75 X 25	3.5	5.35
	2.0	2.93
	2.5	3.60
75 X 40	2.5	4.18
	3.0	4.95
	3.5	6.29
75 X 50	2.0	3.72
	2.5	4.58
	3.0	5.42
	4.0	6.92
100 X 50	5.0	8.35
	6.0	9.67
	3.0	6.60
	4.0	8.49
102 X 76	5.0	10.30
	6.0	12.00
	3.5	9.07
102 X 76	5.0	12.50
	6.0	14.70

SIZE	WALL THICKNESS	WEIGHT
mm	mm	kg/m
125 X 75	3.0	8.96
	4.0	11.60
	5.0	14.20
	6.0	16.70
125 X 51	3.5	9.09
	5.0	12.5
	6.0	14.9
150 X 50	3.0	8.96
	4.0	11.60
	5.0	14.20
150 x 100	6.0	16.70
	4.0	14.80
	5.0	18.20
152 X 76	6.0	21.40
	5.0	16.44
	6.0	19.40
200 x 100	4.0	17.90
	5.0	22.10
	6.0	26.20
	9.0	37.70
250 x 150	5.0	29.90
	6.0	35.60
	9.0	51.80



CIRCULAR HOLLOW SECTIONS

CIRCULAR HOLLOW SECTIONS

AS/NZS 1163:2016 C350LO

AS/NZS 1074

Plain Ends/Square Ends - in 6.5m standard lengths.
Other lengths available upon request

Finish: Painted, NOPC/Bare & Galvanised

Standard Lengths: 6.5m (Plain / Square Ends)

Threaded & Socket pipes also available on request

Different standards/grades and lengths available upon request.



NOMINAL BORE	IMPERIAL EQUIV.	OUTSIDE DIAMETER	WALL THICKNESS	BLACK PE	GALV / PTD
NB		[mm]	[mm]	[kg/m]	[kg/m]
15NB LGT	1/2"	21.30	2.0	0.95	1.00
15NB MED			2.6	1.20	1.25
15NB HVY			3.2	1.44	1.48
20NB XLT	3/4"	26.90	2.0	1.23	1.29
20NB LGT			2.3	1.40	1.46
20NB MED			2.6	1.56	1.62
20NB HVY			3.2	1.87	1.93
25NB XLT	1"	33.70	2.0	1.56	1.64
25NB LGT			2.6	1.99	2.07
25NB MED			3.2	2.41	2.49
25NB HVY			4.0	2.94	3.02
32NB XLT	1 1/4"	42.40	2.0	1.99	2.10
32NB LGT			2.6	2.55	2.65
32NB MED			3.2	3.09	3.20
32NB HVY			4.0	3.8	3.90
40NB XLT	1 1/2"	48.30	2.3	2.61	2.73
40NB LGT			2.9	3.25	3.36
40NB MED			3.2	3.57	3.68
40NB HVY			4.0	4.38	4.49
50NB XLT	2"	60.30	2.3	3.29	3.44
50NB LGT			2.9	4.11	4.25
50NB MED			3.6	5.03	5.18
50NB HVY			4.5	6.19	6.33
65NB LGT	2 1/2"	76.10	3.2	5.75	5.94
65NB MED			3.6	6.43	6.61
65NB HVY			4.5	7.93	8.12

CIRCULAR HOLLOW SECTIONS

AS/NZS 1163:2016 C350LO

AS/NZS 1074

NOMINAL BORE	IMPERIAL EQUIV.	OUTSIDE DIAMETER	WALL THICKNESS	BLACK PE	GALV / PTD
NB		[mm]	[mm]	[kg/m]	[kg/m]
80NB LGT	3"	88.90	3.2	6.76	6.98
80NB MED			4.0	8.38	8.58
80NB HVY			5.0	10.3	10.50
90NB LGT	3 ½"	101.60	3.2	7.77	8.02
90NB MED			4.0	9.63	9.88
90NB HVY			5.0	11.9	12.20
100NB LGT	4"	114.30	3.6	9.83	10.10
100NB MED			4.5	12.2	12.40
100NB HVY			5.4	14.5	14.80
125NB LGT	5"	139.70	3.5	11.8	12.10
125NB MED			5.0	16.6	16.90
125NB HVY			5.4	17.9	18.20
150NB LGT	6"	165.10	3.5	13.9	14.40
150NB MED			5.0	19.7	20.10
150NB HVY			5.4	21.3	21.70



UNIVERSAL BEAMS

UNIVERSAL BEAMS

AS/NZS 3679.1:2016 G300/G300SO/G350SO

Finish: Bare, Painted & Galvanised

Standard Lengths: 9, 10.5, 12, 13.5, 15, 16.5 & 18m.

Different standards/grades and lengths available upon request.



SIZE	MASS PER METRE	DIMENSIONS		THICKNESS	
		DEPTH	WIDTH	FLANGE	WEB
	kg/m	mm	mm	mm	mm
UB 150 x 14	14.0	150	75	7.0	5.0
UB 150 x 18	18.0	155	75	9.5	6.0
UB 180 x 16	16.1	173	90	7.0	4.5
UB 180 x 18	18.1	175	90	8.0	5.0
UB 180 x 22	22.2	175	90	8.0	5.0
UB 200 x 18	18.2	198	99	7.0	4.5
UB 200 x 22	22.3	202	133	7.0	5.0
UB 200 x 25	25.4	203	133	7.8	5.8
UB 200 x 30	29.8	207	134	9.6	6.3
UB 250 x 26	25.7	248	124	8.0	5.0
UB 250 x 31	31.4	252	146	8.6	6.1
UB 250 x 37	37.3	256	146	10.9	6.4
UB 310 x 32	32.0	298	149	8.0	5.5
UB 310 x 40	40.4	304	165	10.2	6.1
UB 310 x 46	46.2	307	166	11.8	6.7
UB 360 x 45	44.7	352	171	9.7	6.9
UB 360 x 51	50.7	356	171	11.5	7.3
UB 360 x 57	56.7	359	172	13.0	8.0
UB 410 x 54	53.7	403	178	10.9	7.6
UB 410 x 60	59.7	406	178	12.8	7.8
UB 460 x 67	67.1	454	190	12.7	8.5
UB 460 x 74	74.6	457	190	14.5	9.1
UB 460 x 82	82.1	460	191	16.0	9.9
UB 530 x 82	82.0	528	209	13.2	9.6
UB 530 x 92	92.4	533	209	15.6	10.2
UB 610 x 101	101.0	602	228	14.8	10.6
UB 610 x 113	113.0	607	228	17.3	11.2
UB 610 x 125	125.0	612	229	19.6	11.9

UNIVERSAL BEAMS

AS/NZS 3679.1:2016 G300/G300SO/G350SO



UNIVERSAL COLUMNS

UNIVERSAL COLUMNS

AS/NZS 3679.1:2016 G300/G300SO/G350SO

Finish: Bare, Painted & Galvanised

Standard Lengths: 9, 10.5, 12, 13.5, 15, 16.5 & 18m.

Different standards/grades and lengths available upon request.



SIZE	MASS PER METRE	DIMENSIONS		THICKNESS	
		DEPTH	WIDTH	FLANGE	WEB
	kg/m	mm	mm	mm	mm
UC 100 x 15	14.8	97	99	7.00	5.00
UC 150 x 23	23.4	152	152	6.83	6.10
UC 150 x 30	30.0	158	153	9.37	6.55
UC 150 x 37	37.2	162	154	11.50	8.13
UC 200 x 46	46.2	203	203	11.50	7.32
UC 200 x 52	52.2	206	204	12.50	8.00
UC 200 x 60	59.5	210	205	14.20	9.27
UC 250 x 73	72.9	254	254	14.20	8.64
UC 250 x 90	89.5	260	256	17.30	10.50
UC 310 x 97	96.8	308	305	15.40	9.91
UC 310 x 118	118.0	315	307	18.70	11.90
UC 310 x 137	137.0	320	309	21.70	13.80
UC 310 x 158	158.0	327	311	25.00	15.70



**PARALLEL
FLANGE
CHANNELS**

PARALLEL FLANGE CHANNELS - PFCs

AS/NZS 3679.1:2016 G300/G300SO/G350SO

Finish: Bare, Painted & Galvanised

Standard Lengths: 9, 10.5, 12, 13.5, 15, 16.5 & 18m.

Different standards/grades and lengths available upon request.



SIZE	MASS PER METRE	DIMENSIONS		THICKNESS	
		DEPTH	WIDTH	FLANGE	WEB
	kg/m	mm	mm	mm	mm
75 x 40	5.92	75	40	6.1	3.8
100 x 50	8.33	100	50	6.7	4.2
125 x 65	11.90	125	65	7.5	4.7
150 x 75	17.70	150	75	9.5	6
180 x 75	20.90	180	75	11	6
200 x 75	22.90	200	75	12	6
230 x 75	25.10	230	75	12	6.5
250 x 90	35.50	250	90	15	8
300 x 90	40.10	300	90	16	8
380 x 100	55.20	380	100	17.5	10



ANGLES

ANGLES

AS/NZS 3679.1:2016 G300

JIS G3101 SS400

Finish: Bare, Painted & Galvanised

Standard Lengths: 6 and 9m.

Different standards/grades and lengths available upon request.



EQUAL ANGLES	
SIZE	MASS PER METRE
mm	kg/m
20 x 20 x 3	0.86
25 x 25 x 3	1.12
25 x 25 x 5	1.65
30 x 30 x 3	1.35
30 x 30 x 5	2.01
30 x 30 x 6	2.56
40 x 40 x 3	1.83
40 x 40 x 5	2.73
40 x 40 x 6	3.5
45 x 45 x 3	2.06
45 x 45 x 5	3.1
45 x 45 x 6	3.97
50 x 50 x 3	2.31
50 x 50 x 5	3.48
50 x 50 x 6	4.46
50 x 50 x 8	5.68
60 X 60 x 6	5.42
60 x 60 x 8	7.09
65 x 65 x 5	4.56
65 x 65 x 6	5.87
65 x 65 x 8	7.51
65 x 65 x 10	9.02
75 x 75 x 5	5.27
75 x 75 x 6	6.81
75 x 75 x 8	8.73
75 x 75 x 10	10.5
80 x 80 x 6	7.34
80 x 80 x 8	9.63

EQUAL ANGLES	
SIZE	MASS PER METRE
mm	kg/m
80 x 80 x 10	11.9
90 x 90 x 6	8.22
90 x 90 x 8	10.6
90 x 90 x 10	12.7
100 x 100 x 6	9.16
100 x 100 x 8	11.8
100 x 100 x 10	14.2
100 x 100 x 12	17.7
125 x 125 x 8	14.9
125 x 125 x 10	18.00
125 x 125 x 12	22.50
150 x 150 x 10	21.9
150 x 150 x 12	27.3
150 x 150 x 16	35.4
200 x 200 x 16	48.7

UNEQUAL ANGLES	
SIZE	MASS PER METRE
mm	kg/m
65 x 50 x 5	4.02
65 x 50 x 6	5.16
75 x 50 x 5	4.4
75 x 50 x 6	5.66
100 x 75 x 6	7.98
100 x 75 x 8	10.3
100 x 75 x 10	12.4
125 x 75 x 6	9.16
125 x 75 x 8	11.8
125 x 75 x 10	14.2
125 x 75 x 12	17.7
150 x 90 x 8	14.3
150 x 90 x 10	17.3
150 x 90 x 12	21.6
150 x 100 x 10	18.0
150 x 100 x 12	22.5



FLAT BARS

FLAT BARS

AS/NZS 3679.1:2016 G300

ASTM A36, EN/10025 S275, JIS SS400, JIS SM400A

Finish: Bare, Painted & Galvanised

Standard Lengths: 6m.

Different standards/grades and lengths available upon request.

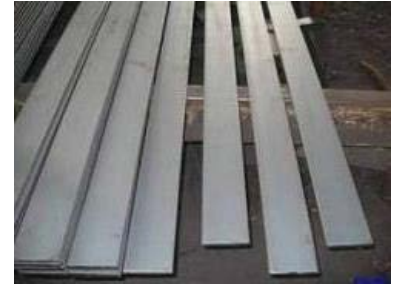

SIZE	MASS PER METRE
mm	kg/m
10 x 3	0.22
13 x 3	0.29
13 x 5	0.47
16 x 3	0.36
16 x 5	0.59
20 x 3	0.47
20 x 5	0.79
20 x 6	0.94
20 x 10	1.57
25 x 3	0.59
25 x 5	0.98
25 x 6	1.18
25 x 8	1.57
25 x 10	1.96
25 x 12	2.36
30 x 5	1.18
30 x 10	2.36
32 x 3	0.75
32 x 5	1.26
32 x 6	1.51
32 x 8	2.01
32 x 10	2.51
40 x 3	0.94
40 x 5	1.57
40 x 6	1.88
40 x 8	2.51
40 x 10	3.14
40 x 12	3.77

SIZE	MASS PER METRE
mm	kg/m
40 x 16	5.02
50 x 3	1.18
50 x 5	1.96
50 x 6	2.36
50 x 8	3.14
50 x 10	3.93
50 x 12	4.71
50 x 16	6.28
50 x 20	7.86
50 x 25	9.82
60 x 6	2.83
60 x 10	4.71
60 x 12	5.65
65 x 3	1.53
65 x 5	2.55
65 x 12	6.12
65 x 16	8.16
65 x 20	10.2
75 x 3	1.77
75 x 5	2.94
75 x 10	5.89
75 x 12	7.06
75 x 16	9.42
75 x 20	11.8
75 x 25	14.7
75 x 40	23.6
80 x 6	3.77
80 x 10	6.28

SIZE	MASS PER METRE
mm	kg/m
80 x 12	7.53
90 x 6	4.24
90 x 10	7.06
100 x 3	2.36
100 x 5	3.93
100 x 6	4.71
100 x 8	6.28
100 x 10	7.85
100 x 12	9.42
100 x 16	12.6
100 x 20	15.7
100 x 25	19.6
110 x 6	5.18
130 x 6	6.12
130 x 10	10.2
130 x 12	12.2
130 x 16	16.3
130 x 20	20.4
130 x 25	25.5
150 x 3	3.53
150 x 5	5.89
150 x 6	7.07
150 x 8	9.42
150 x 10	11.8
150 x 12	14.19
150 x 16	18.8
150 x 20	23.56
150 x 25	29.4

FLAT BARS

AS/NZS 3679.1:2016 G300

ASTM A36, EN/10025 S275, JIS SS400, JIS SM400A

SIZE	MASS PER METRE
mm	kg/m
180 x 6	8.48
180 x 10	14.1
180 x 12	17.0
200 x 6	9.42
200 x 8	12.6
200 x 10	15.7
200 x 12	18.8
200 x 16	25.1
200 x 20	31.4
200 x 25	39.3
250 x 6	11.8
250 x 8	15.7
250 x 10	19.6
250 x 12	23.6
250 x 16	31.4
250 x 20	39.3
250 x 25	49.6
300 x 6	14.1
300 x 8	18.8
300 x 10	23.6
300 x 12	28.3
300 x 16	37.7
300 x 20	47.1
300 x 25	58.9



PLATES

MILD STEEL PLATES

AS/NZS 3678 G250, G300, G350
 AS1594 HA250/300
 JIS G3101 - SS400

Finish: Bare, Painted & Galvanised

Corrosion resistant, boiler and wear resistant plates available upon request.

Different standards/grades and sizes available upon request.

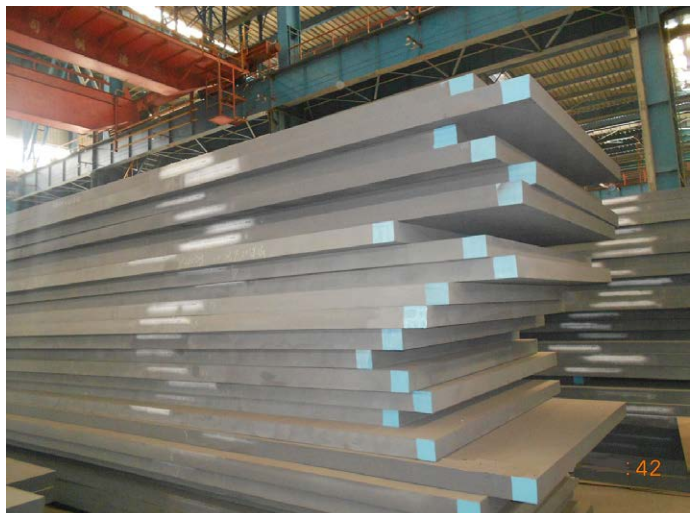
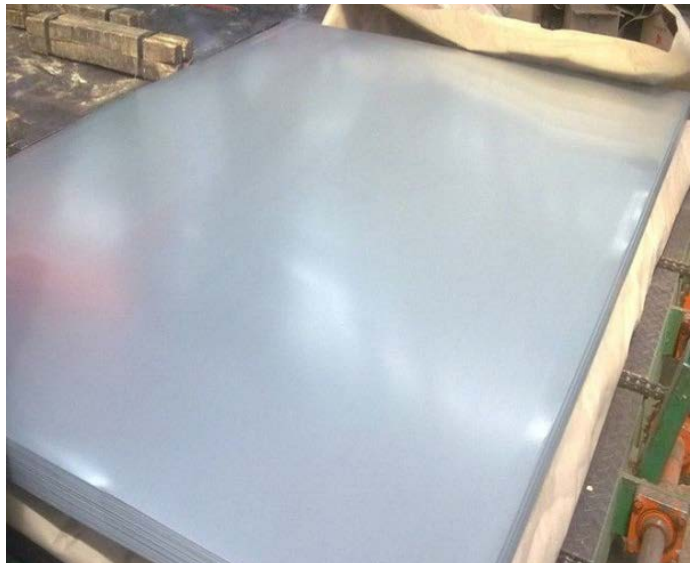

MILD STEEL PLATES	
THICKNESS	WEIGHT
mm	kg/m ²
3	23.55
4	31.40
5	39.25
6	47.10
8	62.80
10	78.50
12	94.20
16	125.60
20	157.0
25	196.25
32	251.2
40	314.0
50	392.5
60	471.0
80	628.0
100	785.0
120	942.0
130	1020.5
150	1177.5
200	1570.0

CHEQUER PLATES	
THICKNESS	WEIGHT
mm	kg/m ²
3	23.55
5	41.35
6	47.20
8	64.90
10	80.60

REBAR

REINFORCING STEEL - REBAR

AS/NZS 4671-2001

G300E, G500 MA (MICRO-ALLOY)



Finish: Bare

Standard Lengths: 6, 9 and 12m

Different standards/grade and lengths available upon request.



ROUND BAR	
SIZE	MASS PER METRE
mm	kg/m
6	0.22
8	0.39
10	0.62
12	0.89
16	1.58
20	2.46
25	3.85
27	4.49
30	5.50
32	6.31
36	7.99
39	9.38
40	9.86

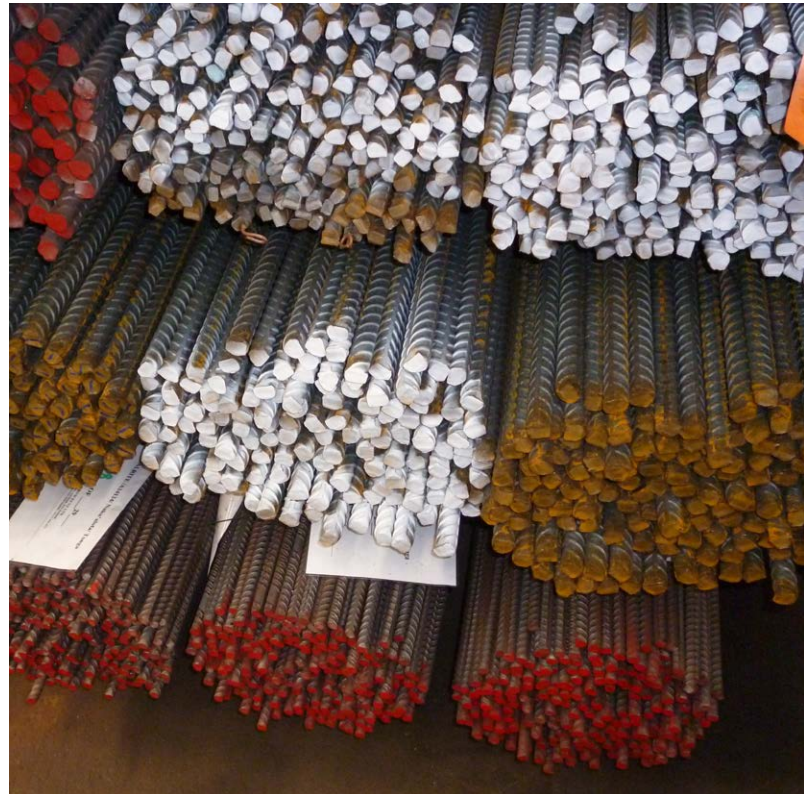

DEFORMED BAR	
SIZE	MASS PER METRE
mm	kg/m
10	0.61
12	0.88
16	1.57
20	2.46
25	3.85
32	6.31

STRAPPING

STEEL STRAPPING

JIS G3141

THICKNESS	WIDTH	WEIGHT
mm	mm	kg/m
0.5	12.7	20
0.5	16	15.9
0.5	19	13.4
0.6	12.7	16.7
0.6	16	13.2
0.6	19	11.1
0.7	19	9.5
0.7	25	7.1
0.7	32	5.7
0.8	19	8.3
0.8	25	6.2
0.8	32	5
0.9	19	7.4
0.9	25	5.5
0.9	32	4.4



27

STRAPPING

STEEL SEAL

JIS G3302

Full Hard Grade, Cold Rolled with Oiled/Galvanized
Width Waxed

THICKNESS	WIDTH	WEIGHT
mm	mm	kg/m
0.65	19.0	23.0
0.95	32.0	50.0



PURLINS

PURLINS

NZS 3604:2011 G450/G500/G550 - Z275, Z450

Finish: Hot Dip Galvanised

SIZE	MASS PER METRE	D X B	BMT
	kg/m	mm	mm
150/12	3.06	150 x 65	1.15
150/15	3.83	150 x 65	1.45
150/18	4.60	150 x 65	1.75
150/23	5.85	150 x 65	2.25
200/12	3.73	200 x 75	1.15
200/15	4.68	200 x 75	1.45
200/18	5.62	200 x 75	1.75
200/23	7.16	200 x 75	2.25
250/13	4.91	250 x 85	1.25
250/15	5.68	250 x 85	1.45
250/18	6.82	250 x 85	1.75
250/23	8.71	250 x 85	2.25
300/15	6.69	300 x 100	1.45
300/18	8.04	300 x 100	1.75
300/23	10.27	300 x 100	2.25
300/30	13.56	325 x 100	2.95
350/18	8.39	325 x 100	1.75
350/23	11.15	350 x 100	2.25
350/24	12.10	350 x 100	2.40
350/30	14.78	350 x 100	2.95
400/20	10.80	400 x 100	1.95
400/23	12.43	400 x 100	2.25
400/24	13.24	401 x 100	2.40
400/30	16.44	401 x 100	2.95

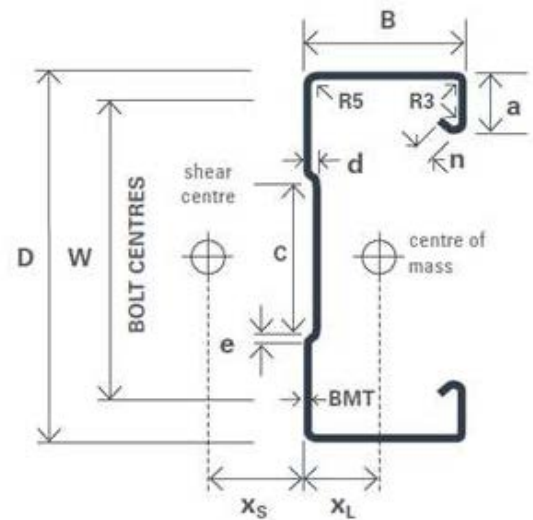

C PURLINS

SIZE	MASS PER METRE	D X B	BMT
	kg/m	mm	mm
100/10	1.70	100 x 50	0.95
100/12	2.03	100 x 50	1.15
100/16	2.68	100 x 50	1.55
100/19	3.08	150 x 65	1.85
150/12	2.70	150 x 65	1.15
150/15	3.39	150 x 65	1.45
150/19	4.30	150 x 65	1.85
150/24	5.52	150 x 65	2.40
200/15	4.35	200 x 75	1.45
200/19	5.52	200 x 75	1.85
200/24	7.11	200 x 75	2.40
250/15	5.10	250 x 85	1.45
250/19	6.48	250 x 85	1.85
250/24	8.35	250 x 85	2.40
300/24 (90)	9.48	300 x 90	2.40
300/24 (100)	9.86	300 x 100	2.40
300/30 (90)	11.78	300 x 90	2.95
300/30 (100)	12.25	300 x 100	2.95
400/24	12.05	400 x 100	2.40
400/30	14.99	400 x 100	2.95

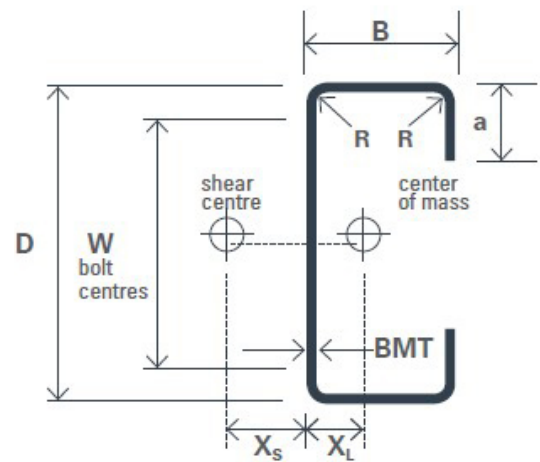

ALRITE PROJECTS



ALRITE PROJECTS

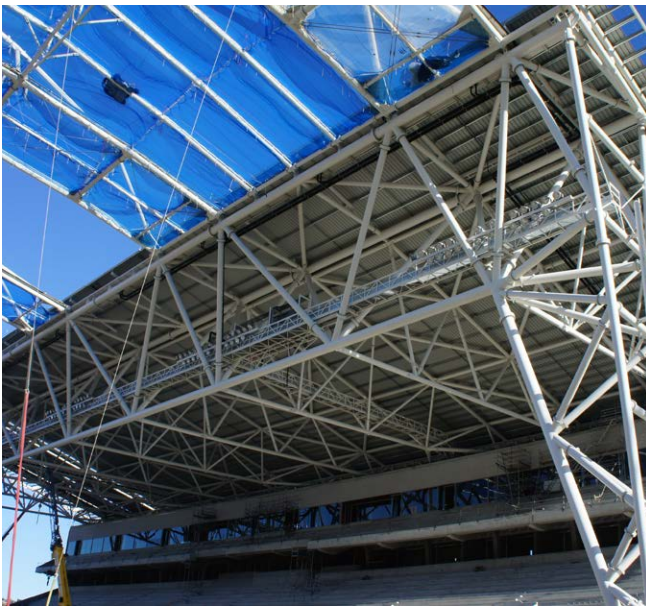

ALRITE PROJECTS



ALRITE PROJECTS





ALRITE STEEL & SERVICES NZ LTD



PO Box 98-967, Manukau,
Auckland 2241, New Zealand
P +64 9 270 2008 **F** +64 9 270 2009
E info@alrite.co.nz **W** www.alrite.co.nz